

**PROMAG<sup>®</sup>**

**SmaFinger<sup>®</sup>**  
Contactless Smart Card & Fingerprint Reader



*Seamless Upgrade*

**SmaFinger<sup>®</sup>**

## Configuration

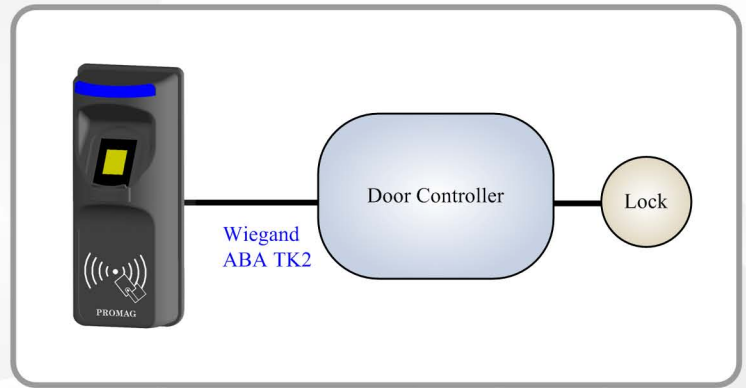

Standalone

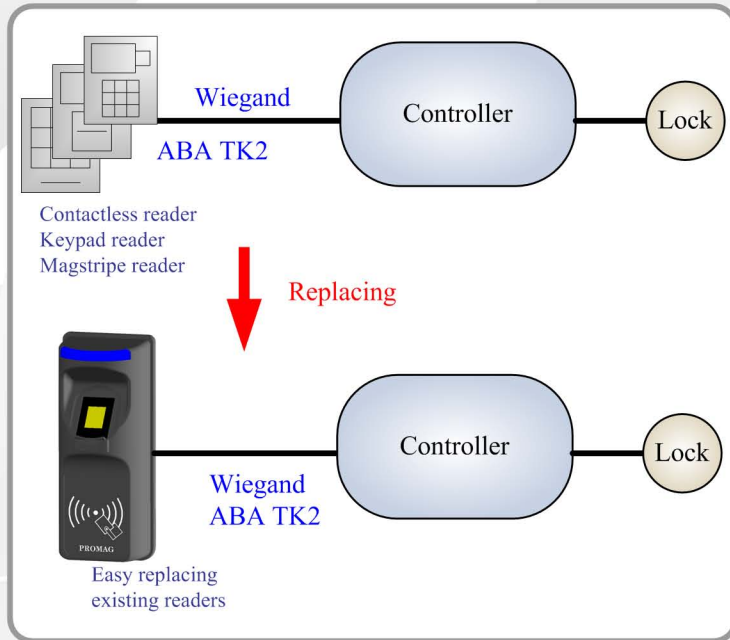

Replacing Existing Reader

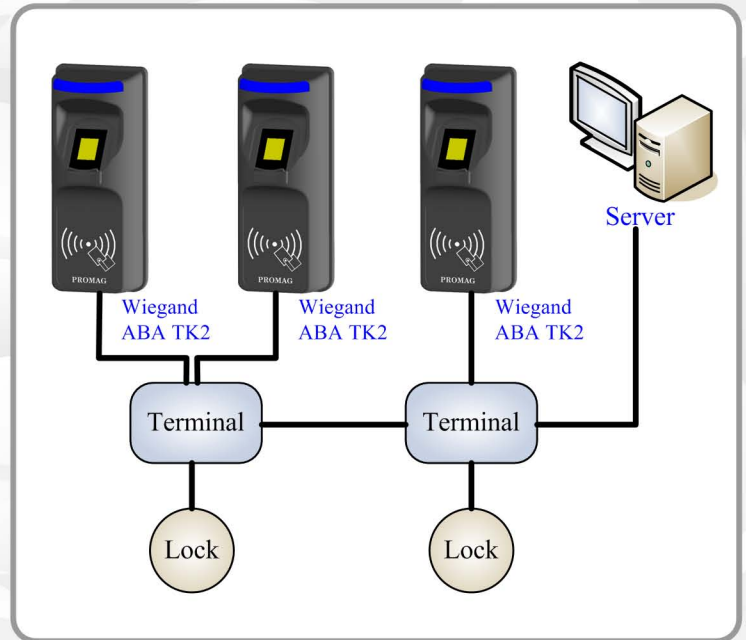

Network

## Usage

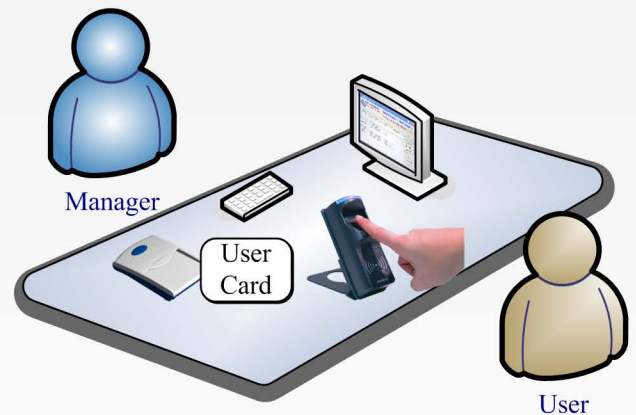

Enrollment



Biometrics



Standalone



Security



Easy Replacing

## Usage for Card + Finger

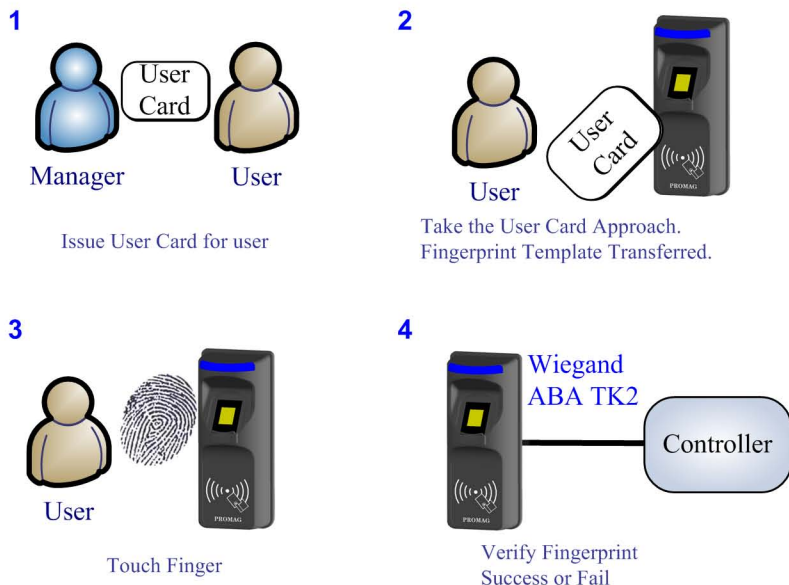

## Usage for Finger Only and Add User

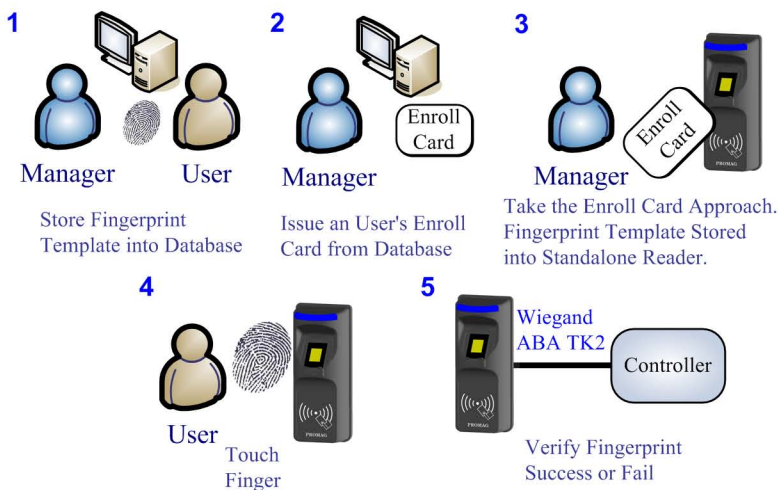

## Delete User

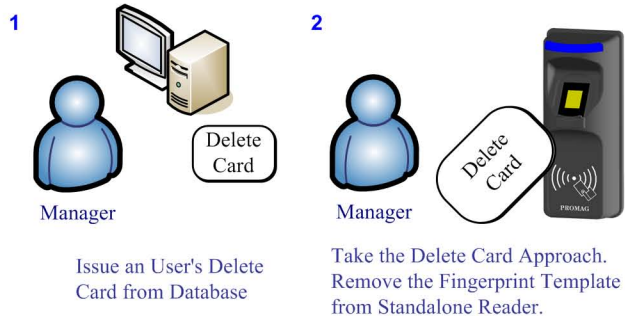

Biometrics



Standalone



Security



Easy Replacing



**S**maFinger is a fingerprint reader developed on the so-called contactless smart card 13.56 Mhz RFID technology. The integration of biometric technology by fingerprint identification and 13.56Mhz RFID technology makes SmaFinger be capable of biometric and contactless performance without spending large amount of expenses in running system upgrading with fingerprint system extension. On the aspect of personal privacy issue, SmaFinger provides the high secure of protection on privacy concern because every fingerprint is stored on a card. Also the reader itself supports Mifare MAD1/MAD2 format to make user end be able to issue their customized ID cards.

### Three Access Modes

- \* Card Only
- \* Card + Fingerprint
- \* Fingerprint only

Mode of Fingerprint only is also able to access functions of card enrollment and deletion. No need to apply extra on-line system or equipment to build up the fingerprint database.

### Applications

- \* Time attendance.
- \* Access control and Hotel locker management.
- \* Credit card or card cash.
- \* Membership card.
- \* Drive license or personal ID identification.
- \* Log in system.
- \* Wiegand devices or ABA-TK2 compatible.

### Keynotes

High secure of protection for loss of ID card (Unduplicated ).

Card + Fingerprint supports limitless fingerprint capacity.

Featuring 3 interfaces in one devices - Wiegand, RS232 and ABA-TK2.

Low risk of privacy intrusion

Supports Mifare MAD 1/MAD 2 format, available for customized definitions and card issuing.

SmaFinger	Model No.		SF500	SF600
	Application		Standalone Mifare Sector Reader	
Access Mode	Card Only		Supported	
	Card + Fingerprint	Enroll Mode	No Need	
		Fingerprint Capacity	Unlimited	
		Fingerprint Validation	1:1	
		Performance	Security	
	Fingerprint Only	Enroll Mode	RS232 or Enroll Card	
		Fingerprint Capacity	10	1900
		Fingerprint Validation	1:10	1:N
		Performance	Friendly	
Mifare Card	Max Fingerprint Template Capacity		2	
	Mifare Card Type		1K /4K	
	Card Format		For MAD1/MAD2 Only	
Reader	Configurable Interface		RS232 : 2400~57600 bps Wiegand: 26~128 bits ABA-TK2: 2~24 Digital Codes	
	Identification speed		<2 sec (1:1) <5 sec (1:10)	<1 sec (1:1) <3 sec (1:N)
	Mifare Read Distance		Max. 50mm	
	Power Consumption		Max. 200mA @ DC12V	



集佳股份有限公司  
GIGA-TMS INC.

8F, No. 31 Lane 169, Kang-Ning St,  
Hsi-Chih, Taipei County, Taiwan 221

Tel: + 886-2-26954214

Fax: + 886-2-26954213

E-mail: promag@gigatms.com.tw

URL: www.gigatms.com.tw

## SmaFinger® TCP/IP RFID Fingerprint Reader

SmaFinger 650 is a biometric fingerprint reader that identifies users by fingerprints as well as ID cards. It also comes with a fingerprint + card option that can store digitized fingerprints on the card instead of system database. While having all the features and functions of other fingerprint readers sold in the market, what makes SF650 stand out is its fast response fingerprint reading feature. You might have experienced readers that are slow to read correctly placed fingers or failing to read instances of angular placement but thanks to Advanced Minutiae Based Algorithm (AMBA) and GIGA-TMS exclusive engineering, SF650 is the fastest recognizing fingerprint reader in its class and its quick response time has impressed our satisfied customers – both system integrators and end users.

### Specifications:

Standard communication	TCP/IP (10/100 Base) , RS232, RS485, Wiegand, ABA TK2
RF characteristic	13.56MHz ISO14443A
Voltage	Operating DC9-20V
Power consumption	Max 200mA@ DC12V
Reading distance	Up to 5 cm (Mifare card 1K/4K)
Dimension	130L x 54W x 43H
Internet protocol	TCP, UDP, DHCP-client, SNTP, UPnP, Locator
Inside server	Web server, GNetplus, NET
Supported browser	IE, Safari, Firefox, Chrome
Indicator	LED 3 colors
Mifare Application directory	Configurable MAD1, MAD2
Fingerprint	Capacitive (Sensor type)
Enrollment	Card only, Fingerprint only, Card + Fingerprint
Template capacity	1900 (Fingerprint)
Resolution	508 dpi (Fingerprint sensor)

\* Specification is subject to change without notice.



### Order information:

SF650 Capacitor type  
SF650-OP Optical type

### GIGA-TMS INC.

8F, NO. 31, LANE 169, KANG-NING STREET,  
HSI-CHIH DIST, NEW TAIPEI CITY, TAIWAN  
Tel: 886-2-26954214 Fax: 886-2-26954213  
<http://www.gigatms.com.tw/>  
Email: [promag@gigatms.com.tw](mailto:promag@gigatms.com.tw)  
[promag@ms24.hinet.net](mailto:promag@ms24.hinet.net)

SF650 has the standard TCP/IP interface and its Web Management Discover software is designed for single and multiple reader configuration installed anywhere in the world. All said, seeing is believing. Please contact our sales representatives and ask for details of the lightning fast SmaFinger 650 reader and experience it for yourself.



[www.logiscenter.com](http://www.logiscenter.com)  
902 050 030



[www.logiscenter.it](http://www.logiscenter.it)  
02 479 216 97



[www.logiscenter.de](http://www.logiscenter.de)  
info@logiscenter.de



[www.logiscenter.pt](http://www.logiscenter.pt)  
308 800 842

## About LOGISCENTER

Grupo Logiscenter is the leading provider in Europe of automatic identification and data capture equipments. Our products include barcode printing and reading devices, mobile computing devices, wireless access points, identification cards, and consumables.

## Reasons to work with us

**Our customers come first.** Our objective is not only selling our products but also holding a long-lasting relationship with our customers, based on the benefits and advantages we create for you and your company.

**The best brands.** We offer products from the best manufacturers worldwide.

**Expert technical support team.** Our support staff are experts in the products we sell. But not just the products, they can tell you the best solution for your particular problem or need.

**Largest stock.** We have a permanent stock of more than 12,000 products.

**Same-day shipping.** For all orders placed and confirmed before 16:00 on working days.

**Best prices.** With Logiscenter, you can be sure that you are paying a fair price for your products we will not overcharge you.

**Easy returns.** Damaged or defective products can be returned easily, for an exchange or reimbursement.

## Solutions for: Industry • Consumer • Mobility Transportation and Logistics • Retail • Health



Label printers



Barcode readers



Data terminals & PDA



PVC card printers

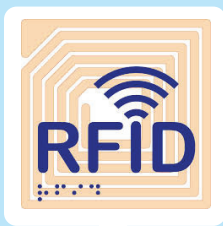

RFID



Consumables  
(labels, ribbons, PVC cards)

## Our Brands



MOTOROLA



Intermec®

Honeywell®

DATALOGIC™



datamax • o'neil

Metrologic

LXE

EPSON®

elo

star

unitech

PRINTRONIX

symbol®



All Brands  
Technical Service